

Part Number: PT925-60240**Kit Contents**

Item #	Quantity Req'd.	Description
1	1	Left Hand Step Tube
2	1	Right Hand Step Tube

Hardware Bag Contents

Item #	Quantity Req'd.	Description
1	1	Bolt Kit
2		
3		

Additional Items Required For Installation

Item #	Quantity Req'd.	Description
1		
2		
3		

Conflicts

None

Recommended Tools

Personal & Vehicle Protection	Notes
Safety Glasses	
Special Tools	Notes
Installation Tools	Notes
12mm Socket	
Ratchet	
Torque Wrench	0-50 N-m (0-37 ft-lbf)
Panel Pry Tool	Toyota SST 00002-06001-01
Special Chemicals	Notes

General Applicability

MY24 and newer Land Cruiser models

Recommended Sequence of Application

Item #	Accessory
1	
2	

*Mandatory

Vehicle Service Parts (may be required for reassembly)

Item #	Quantity Req'd.	Description
1	12	90119-A0582 Bolt
2		
3		

Legend**STOP:** Damage to the vehicle may occur. Do not proceed until process has been complied with.**OPERATOR SAFETY:** Use caution to avoid risk of injury.**CAUTION:** A process that must be carefully observed in order to reduce the risk of damage to the accessory/vehicle and to ensure a quality installation.**TOOLS & EQUIPMENT:** Used in Figures calls out the specific tools and equipment recommended for this process.**REVISION MARK:** This mark highlights a change in installation with respect to previous issue.**SAFETY TORQUE:** This mark indicates that torque is related to safety.

PT925-60240

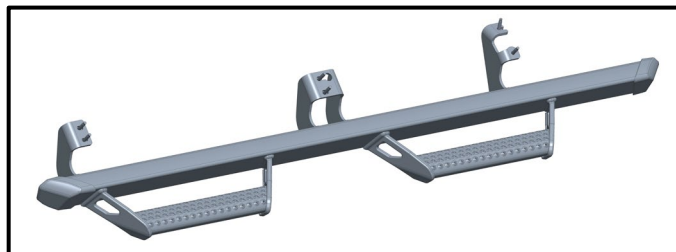

Procedure

Care must be taken when installing this accessory to ensure damage does not occur to the vehicle. The installation of this accessory should follow approved guidelines to ensure a quality installation.

These guidelines can be found in the "Accessory Installation Practices" document.

This document covers such items as: -

- Vehicle Protection (use of covers and blankets, cleaning chemicals, etc.).
- Safety (eye protection, rechecking torque procedure, etc.).
- Vehicle Disassembly/Reassembly (panel removal, part storage, etc.).
- Electrical Component Disassembly/Reassembly (battery disconnection, connector removal, etc.).

Please see your Toyota dealer for a copy of this document.

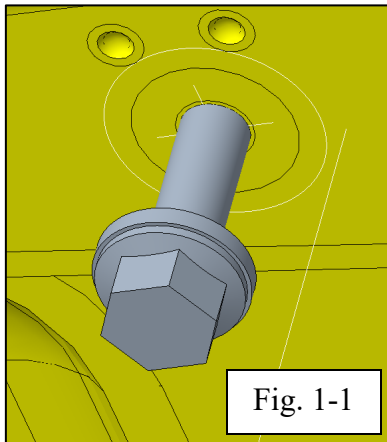

Fig. 1-1

1. Running Board Installation - RH

- (a) Open the box and check the kit for complete contents and any damage.
- (b) Using a 12mm socket, remove & discard twelve OE Hex bolts from underneath the vehicle, 6 per side (Fig. 1-1, Fig. 1-2)

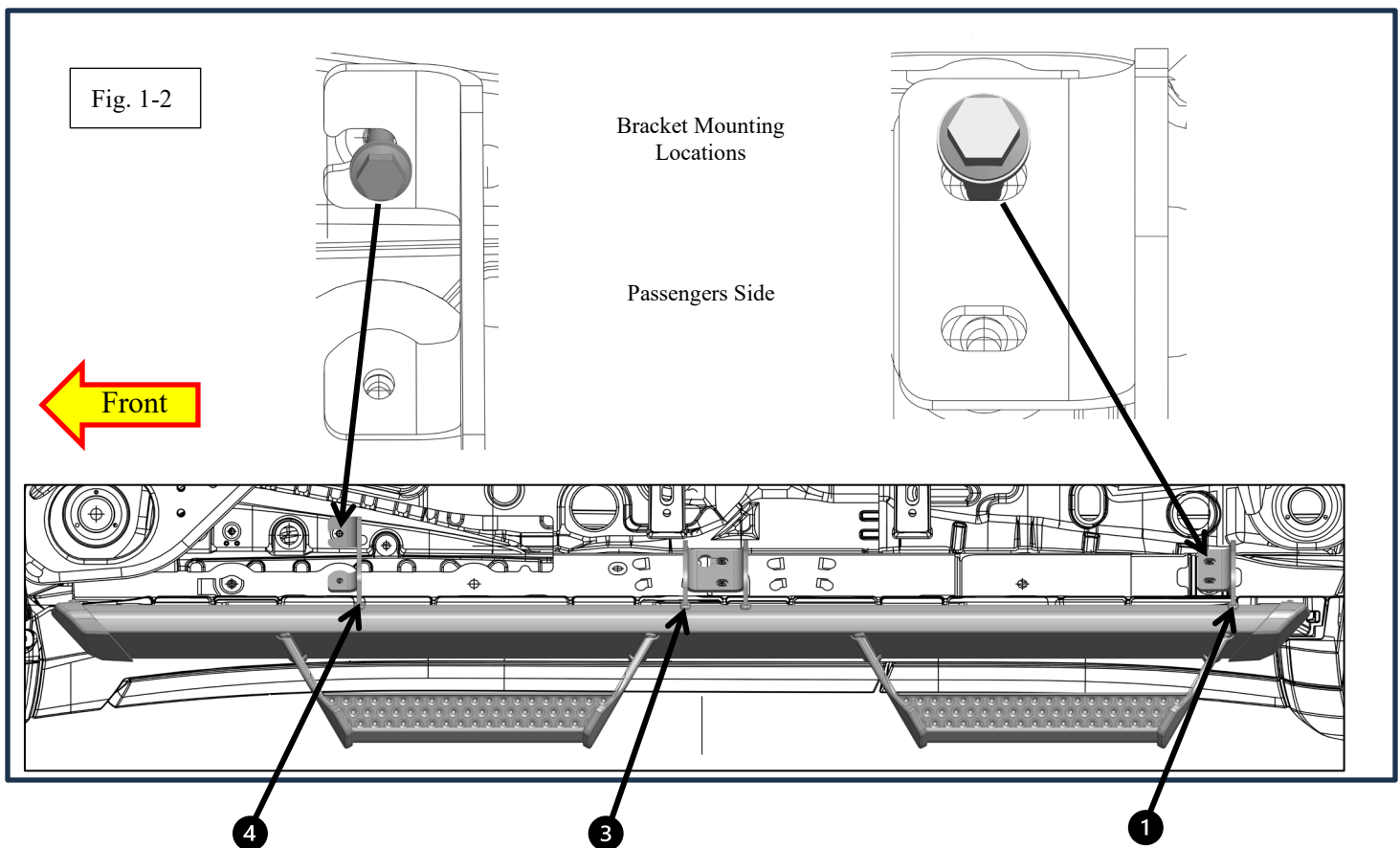
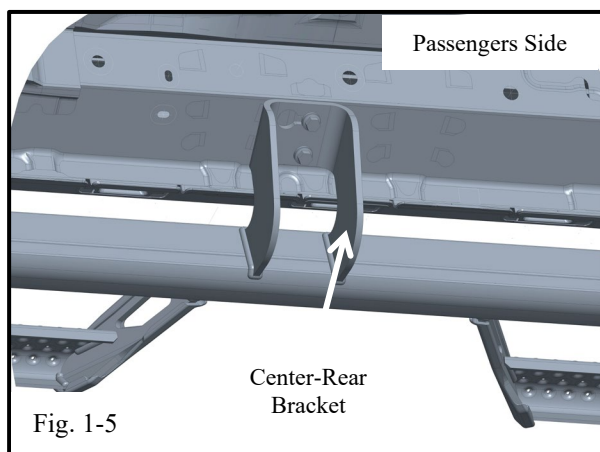
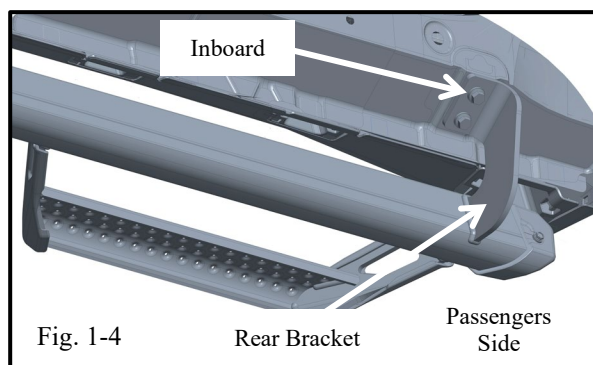
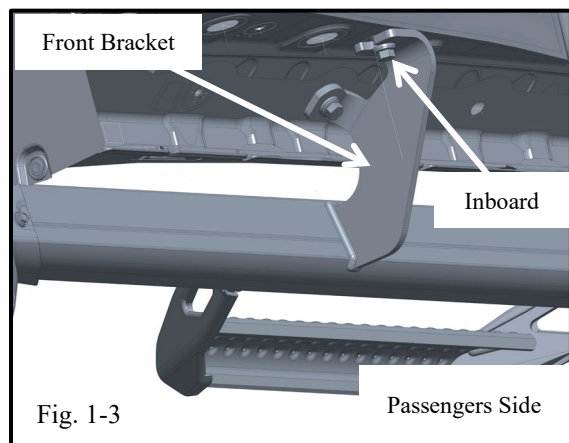

Fig. 1-2

Bracket Mounting
Locations

Passengers Side

Front



⚠ NOTE: For the following steps, the use of a non-impacting type electric hand tool can be used to drive the bolts so long as the bolt does not reach or exceed the specified torque. **Leave all hardware loose at this time.**

- (c) Hand start one 12mm bolt into the inboard factory threaded hole on the front bracket location at least 4 threads (Fig. 1-3).
- (d) Hand start one 12mm bolt into the inboard factory threaded hole on the middle bracket location at least 4 threads (Fig. 1-4).
- (e) Hang board on pre-threaded bolts in Fig.1-2
- (f) Hand start all remaining 12mm bolts at each bracket location (Fig. 1-2). Note: Leave hardware loose at this time.

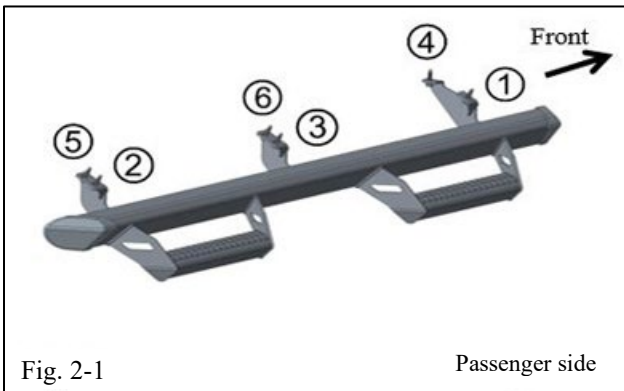

2. Tighten all Hardware.

- (a) In numerical order, tighten (but do not torque) the bolts shown in Fig. 2-1.

3. Torque all Hardware.

- (a) Follow the tightening sequence in Fig. 2-1 to torque the “outside bolts” ① through ③

NOTE: Make sure the bracket is seated to the body before torquing.

4. Torque: 34 Nm (25 lb-ft)

- (a) Follow the tightening sequence in Fig. 3-1 to torque the “inside bolts” ④ through ⑥
- (b)

Torque: 34 Nm (25 lb-ft)

5. Running Board Installation - LH

- (a) Repeat Steps 1 through 3 on the driver’s side.

6. Re-torque all Hardware.

- (a) Re-torque all twelve 8mm Hex Bolts in the same order as Step 3.

Torque: 34 Nm 34 Nm (25 lb-ft)

Checklist - these points **MUST** be checked to ensure a quality installation.

Check:	Look For:
<u>Accessory Function Checks</u> <input type="checkbox"/> Step alignment & torque <input type="checkbox"/> Inspect bolt torques <input type="checkbox"/> <input type="checkbox"/>	 Torque: 34 Nm 34 Nm (25 lb-ft)
<u>Vehicle Function Checks</u> <input type="checkbox"/> No interference between step & vehicle <input type="checkbox"/> <input type="checkbox"/>	Pinch weld contact
<u>Vehicle Appearance Check</u> <input type="checkbox"/> After accessory installation and removal of protective cover(s), perform a visual inspection.	Ensure no damage (including scuffs and scratches) was caused during the installation process. (For PPO installations, refer to TMNA Accessory Quality Shipping Standard.)