

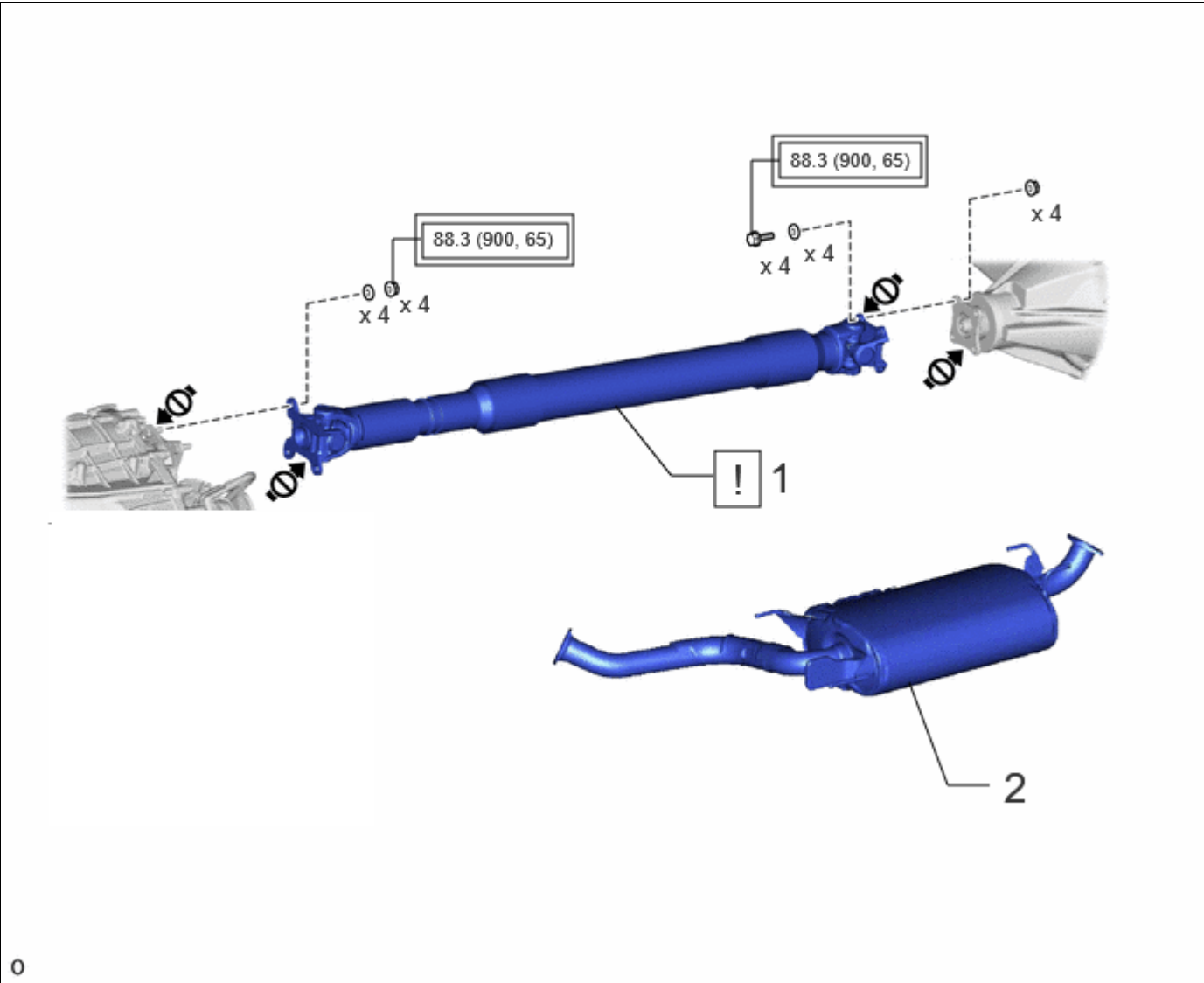



Last Modified: 07-05-2024	6.11:8.1.0	Doc ID: RM100000002K0NG
Model Year Start: 2024	Model: Land Cruiser	Prod Date Range: [02/2024 -]
Title: DRIVE SHAFT / PROPELLER SHAFT: PROPELLER SHAFT ASSEMBLY: INSTALLATION; 2024 MY Land Cruiser [02/2024 -]		



INSTALLATION

CAUTION / NOTICE / HINT

COMPONENTS (INSTALLATION)

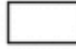

PROCEDURE		PART NAME CODE			
1	REAR PROPELLER SHAFT ASSEMBLY	37110F	INFO	-	-
2	CENTER EXHAUST PIPE ASSEMBLY	-	-	-	-

	Tightening torque for "Major areas involving basic vehicle performance such as moving/turning/stopping": N*m (kgf*cm, ft.*lbf)		N*m (kgf*cm, ft.*lbf): Specified torque
	Do not apply lubricants	-	-

PROCEDURE

1. INSTALL REAR PROPELLER SHAFT ASSEMBLY

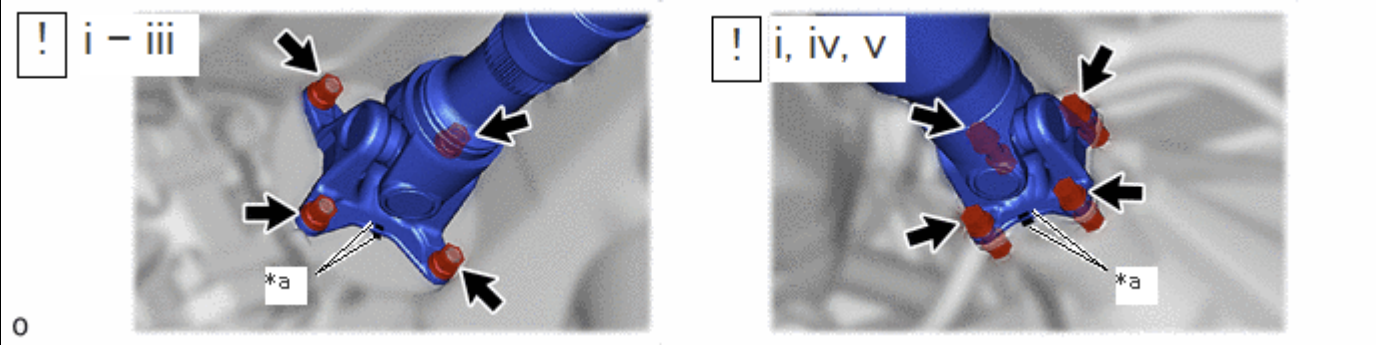

*a	Matchmark	-	-
----	-----------	---	---

- (1) Completely remove any oil, etc. and clean the contact surfaces of the 2 propeller shaft flanges, differential flange and transfer flange.
- (2) Align the matchmarks on the propeller shaft flange and transfer flange.
- (3) Install the rear propeller shaft assembly with the 4 nuts.

Torque:

88.3 N·m {900 kgf·cm, 65 ft·lbf}

- (4) Align the matchmarks on the propeller shaft flange and differential flange.
- (5) Install the rear propeller shaft assembly with the 4 nuts, 4 bolts and 4 washers.

Torque:

88.3 N·m {900 kgf·cm, 65 ft·lbf}

2. INSTALL CENTER EXHAUST PIPE ASSEMBLY

Click here [INFO](#)

