

Part Number: PT925-60240

Kit Contents

| Item # | Quantity Req'd. | Description |
|--------|-----------------|----------------------|
| 1 | 1 | Left Hand Drop Step |
| 2 | 1 | Right Hand Drop Step |
| | | |
| | | |

Hardware Bag Contents

| Item # | Quantity Req'd. | Description |
|--------|-----------------|-------------|
| 1 | 12 | M8 Bolts |
| 2 | | |
| 3 | | |
| | | |

Additional Items Required For Installation

| Item # | Quantity Req'd. | Description |
|--------|-----------------|-------------|
| 1 | | |
| 2 | | |
| 3 | | |
| | | |

Conflicts

| |
|---------------------------------------|
| Illuminated Running Boards/Rock Rails |
|---------------------------------------|

Recommended Tools

| | |
|--|------------------------------|
| Personal & Vehicle Protection | Notes |
| Safety Glasses | |
| | |
| | |
| Special Tools | Notes |
| | |
| | |
| | |
| Installation Tools | Notes |
| 12mm Deep Socket | |
| Ratchet | |
| Torque Wrench | 0-50 N-m (0-37 ft-lbf) |
| Panel Pry Tool | Toyota SST 00002-06001-01 |
| Socket Extension | Optional |
| Special Chemicals | Notes |
| | |
| | |

General Applicability

| |
|------------------------------------|
| MY24 and newer Land Cruiser models |
|------------------------------------|

Recommended Sequence of Application







| Item # | Accessory |
|--------|-----------|
| 1 | |
| 2 | |
| | |

*Mandatory

Vehicle Service Parts (may be required for reassembly)

| Item # | Quantity Req'd. | Description |
|--------|-----------------|------------------|
| 1 | 12 | 90119-A0582 Bolt |
| 2 | | |
| 3 | | |
| | | |

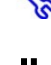
Legend

| | |
|---|--|
|  | STOP: Damage to the vehicle may occur. Do not proceed until process has been complied with. |
|  | OPERATOR SAFETY: Use caution to avoid risk of injury. |
|  | CAUTION: A process that must be carefully observed in order to reduce the risk of damage to the accessory/vehicle and to ensure a quality installation. |
|  | TOOLS & EQUIPMENT: Used in Figures calls out the specific tools and equipment recommended for this process. |
|  | REVISION MARK: This mark highlights a change in installation with respect to previous issue. |
|  | SAFETY TORQUE: This mark indicates that torque is related to safety. |

PT925-60240

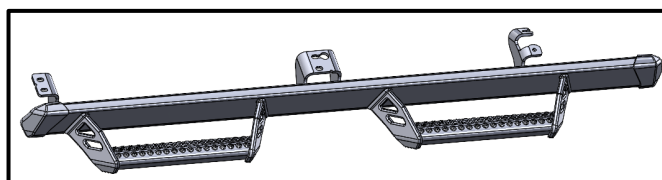

Procedure

Care must be taken when installing this accessory to ensure damage does not occur to the vehicle. The installation of this accessory should follow approved guidelines to ensure a quality installation.

These guidelines can be found in the "Accessory Installation Practices" document.

This document covers such items as:-

- Vehicle Protection (use of covers and blankets, cleaning chemicals, etc.).
- Safety (eye protection, rechecking torque procedure, etc.).
- Vehicle Disassembly/Reassembly (panel removal, part storage, etc.).
- Electrical Component Disassembly/Reassembly (battery disconnection, connector removal, etc.).

Please see your Toyota dealer for a copy of this document.

1. Preparation.



- (a) Parts are heavy. They may require 2 people for lifting and/or installation.



- (b) Read the entire instruction sheet before beginning the installation.



- (c) If vehicle is equipped with Illuminated Running Boards, do not proceed with installation.



- If the vehicle does not have Running Boards, skip step 2



2. Remove Running Boards

- (a) Instructions for LH running board shown. Repeat removal steps for RH side part. (Fig. 2-1)
- (b) Locate and remove running board bolts (6 bolts total per side).
- (c) Remove running boards. Discard running boards and bolts removed on step 2 (b)

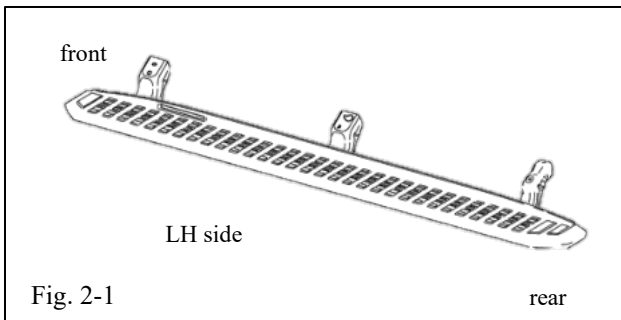

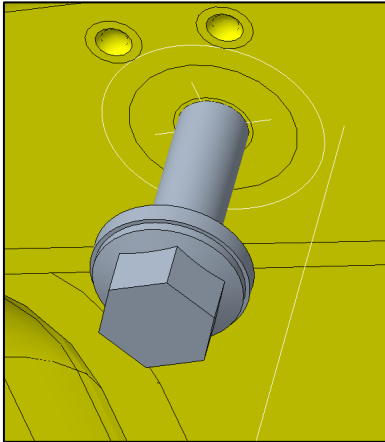
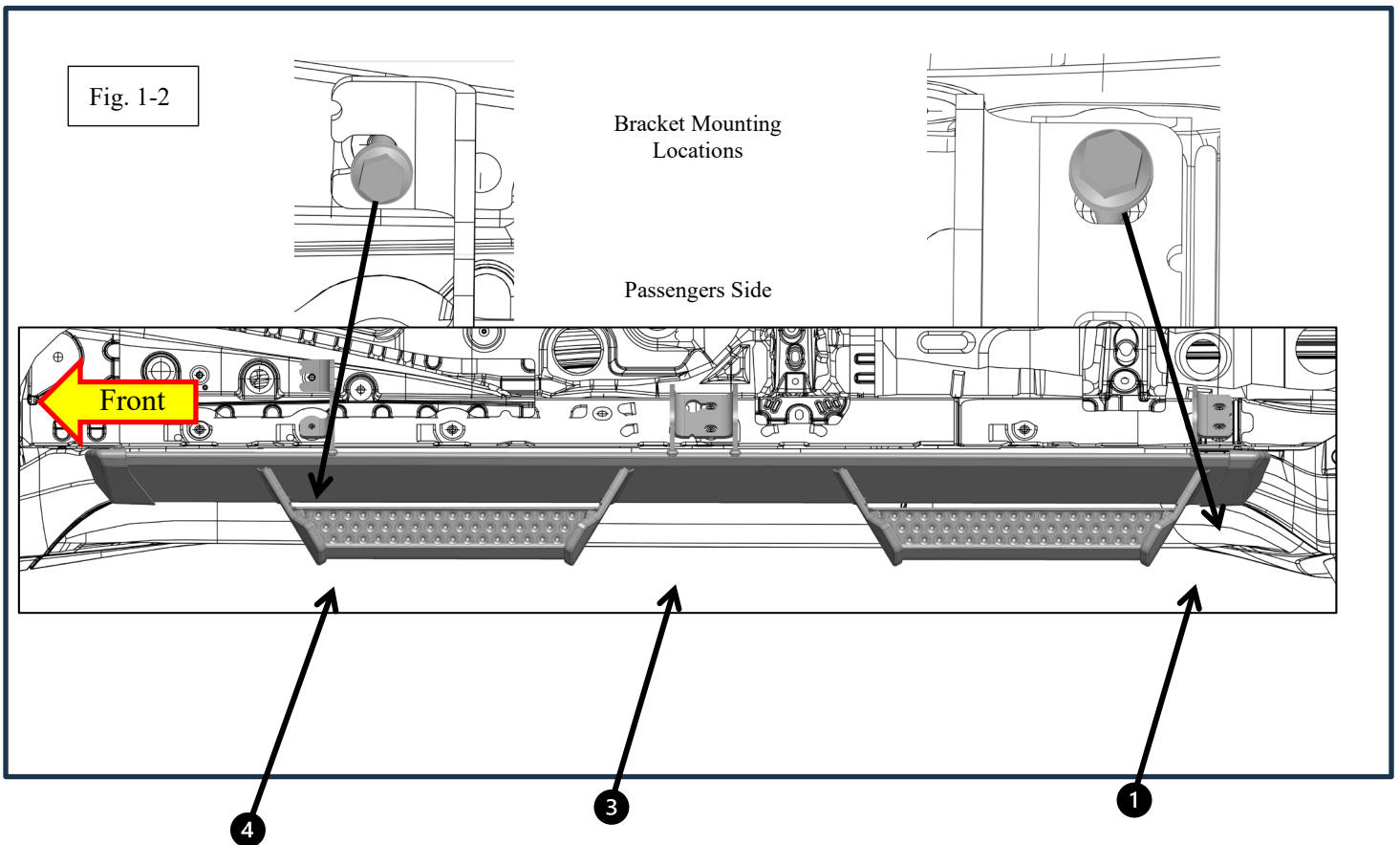

Fig. 1-1

3. Running Board Installation - RH

- (a) Open the box and check the kit for complete contents and any damage.
- (b) Using a 12mm deep socket (or extension), remove & do NOT reuse the twelve OE Hex bolts underneath the vehicle, 6 per side (Fig. 1-1, Fig. 1-2)

⚠ NOTE: The bolts pre-installed in the vehicle are not for running board attachment.



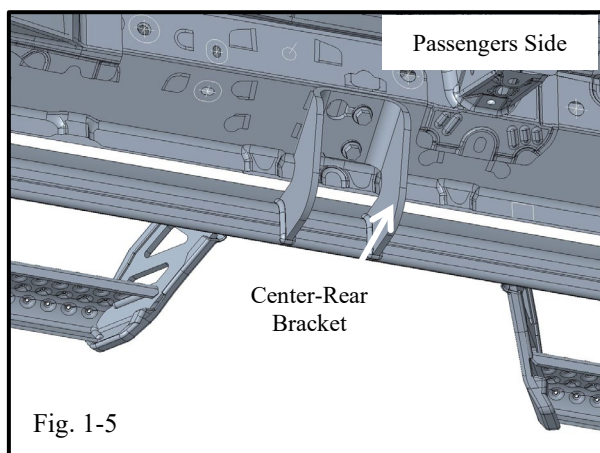
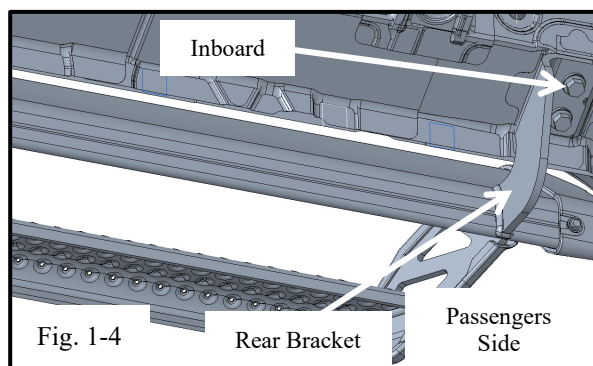
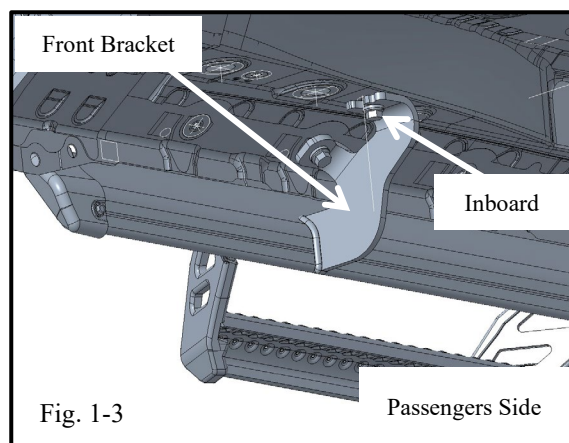

NOTE: For the following steps, the use of a non-impacting type electric hand tool can be used to drive the bolts so long as the bolt does not reach or exceed the specified torque. **Leave all hardware loose at this time.**

- (c) **Using the bolts provided with the running board**, hand start one 8mm bolt into the inboard factory threaded hole on the front bracket location at least 4 threads (Fig. 1-3).
- (d) Hand start one 8mm bolt into the inboard factory threaded hole on the middle bracket location at least 4 threads (Fig. 1-4).
- (e) Hang board on pre-threaded bolts in Fig.1-2
- (f) Hand start all remaining 8mm bolts at each bracket location (Fig. 1-2). Note: Leave hardware loose at this time.

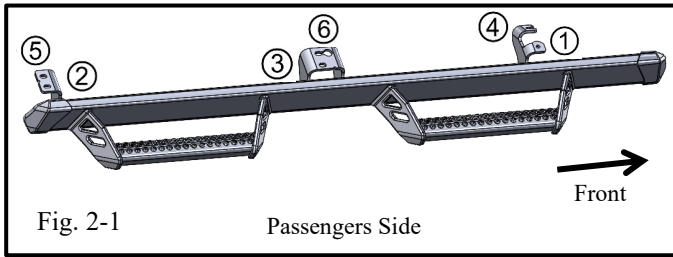

4. Tighten all Hardware.

- (a) In numerical order, tighten (but do not torque) the bolts shown in Fig. 2-1.

5. Torque all Hardware.

- (a) Follow the tightening sequence in Fig. 2-1

Torque: 34 Nm/25ft-lb

6. Running Board Installation - LH

- (a) Repeat Steps 1 through 3 on the driver's side.

7. Re-torque all Hardware.

- (a) Re-torque all twelve 8mm Hex Bolts in the same order as Step 3.

Torque: 34 Nm/25ft-lb

TOYOTA LAND CRUISER HV 2024 -

PREDATOR DROP STEPS

Checklist - these points **MUST** be checked to ensure a quality installation.

| Check: | Look For: |
|--|--|
| <div><div>Accessory Function Checks</div><div><div><input type="checkbox"/> Step alignment & torque</div><div><input type="checkbox"/> Inspect bolt torques (34 Nm/25 ft-lb)</div><div><input type="checkbox"/></div><div><input type="checkbox"/></div></div></div> | |
| <div><div>Vehicle Function Checks</div><div><div><input type="checkbox"/></div><div><input type="checkbox"/></div><div><input type="checkbox"/></div></div></div> | |
| <div><div>Vehicle Appearance Check</div><div><div><input type="checkbox"/> After installation, ensure no damage was incurred.</div></div></div> | <div>Ensure no damage (including scuffs and scratches) was caused during the installation process. (For PPO installations, refer to TMNA Accessory Quality Shipping Standard.)</div> |